



# Star Windows New Construction Window Installation Guidelines

(For Single Hung, Fixed Windows, and Horizontal Sliders)

These installation guidelines are provided by **Star Windows Corporation** to assist in the installation of single-hung, fixed, and horizontal sliding windows. If additional assistance is needed, please visit [www.starwindowscorp.com](http://www.starwindowscorp.com).

## Precautions

- Read these instructions in their entirety before proceeding.
- **Star Windows is not responsible for installation errors or defects;** the responsibility lies solely with the consumer.
- These guidelines may not be appropriate for all building types. Review **state and local building codes** before installation.
- For additional guidance, refer to industry standards such as **AAMA 2400, AAMA InstallationMasters™, ASTM E 2112.**
- These guidelines may not be reproduced in contracts without prior written consent from **Star Windows Corporation.**

## Important Considerations

✓ Window installation may disturb existing structures or finishes. ✓ Materials removed from the site may require proper disposal. See **Section 6** for recycling and disposal guidance. ✓ Safety is critical—ensure **all tools, materials, and products are handled under proper supervision** to prevent injury or damage. ✓ **Removing Old Windows:** If replacing an existing window, follow **safe removal practices**. If lead-based paint is present, consult [www.epa.gov/lead](http://www.epa.gov/lead) for guidance.

## Tools & Materials Required

### Tools

✓ J-Roller ✓ Tape Measure ✓ Hammer ✓ Utility Knife ✓ Square ✓ Caulk Gun ✓ Level



## Materials

✓ **Non-compressible shims** ✓ **Fasteners** (Type and number as required by code; must penetrate rough framing by 1" or more) ✓ **Seal tape** (for weather-resistant barrier) ✓ **Self-adhering flashing** (Minimum 4" wide or as required by code) ✓ **High-quality, compatible exterior-grade sealant** ✓ **Backer rod** ✓ **Low-expansion, low-pressure foam or batt insulation**

## Step 1: Preparing the Rough Opening

Before installing the window, the rough opening must be **level, plumb, and square**. It should be strong enough to support the window and integrate with the **building's water management system**.

### For Existing Weather-Resistant Barrier (WRB):

1. **Cut an "I" shape in the WRB:**
  - **Horizontally across the head and sill**
  - **Two vertical cuts from head to sill**
2. **Fold WRB flaps into the opening** and secure them temporarily with tape.
3. **Cut two 45-degree slits at the head** and fold the WRB outward. Tape it temporarily—this will be used later to integrate the head flashing.

## Step 2: Flashing and Shimming the Opening

Flashing is critical for preventing water infiltration. **Star Windows recommends pan flashing with an interior air dam**. Follow these steps:

1. **Cut the flexible self-adhering flashing** at least **12" longer than the rough opening width**.
2. **Center the flashing** over the sill with at least **6" extending up each jamb**.
3. **Press flashing down into the jamb-sill corners** and smooth it with a **J-Roller**.
4. **Apply additional flashing up the jambs** to ensure a watertight seal.
5. **Place non-compressible shims** at each corner of the sill plate (more may be needed for larger windows).

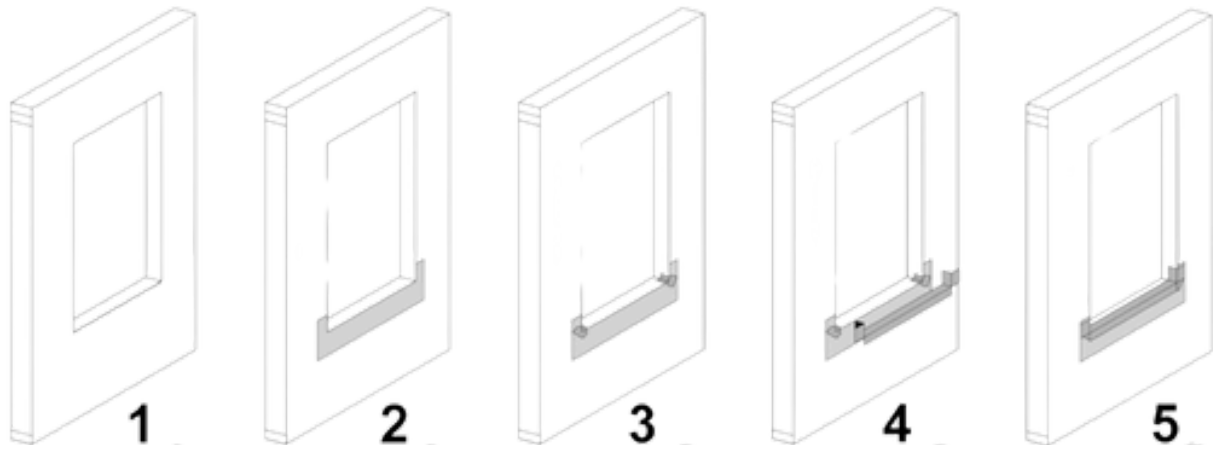

### Step 3: Sealing & Securing the Window

1. **Pre-drill fastener locations for aluminum windows** to prevent distortion.
2. **Inspect and apply sealant at:**
  - **Frame joints**
  - **Mechanically fastened corners**
  - **Full length of mounting fins**
3. **Apply a 3/8" bead of premium exterior sealant** to the backside of the mounting fins at the head, sill, and jambs.
4. **Set the window into the rough opening**, starting with the sill first.
5. **Temporarily fasten the window** at the head corners and verify it is level, plumb, and square.
6. **Shim as needed** to maintain squareness, then fully fasten the window with code-approved fasteners.

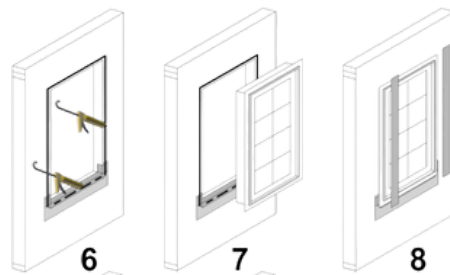

1.

### Step 4: Applying Flashing & Sealing WRB

1. **Cut two pieces of flashing for the jambs**, extending 1" above the head mounting fin and 1" below the sill flashing.
2. **Apply flashing over the jamb mounting fins** and press it down with a J-Roller.
3. **Cut and apply head flashing**, ensuring it overlaps jamb flashing by 1".
4. **Remove temporary tape from the WRB flap** and fold it over the head flashing.
5. **Seal the WRB to the flashing** using seal tape.

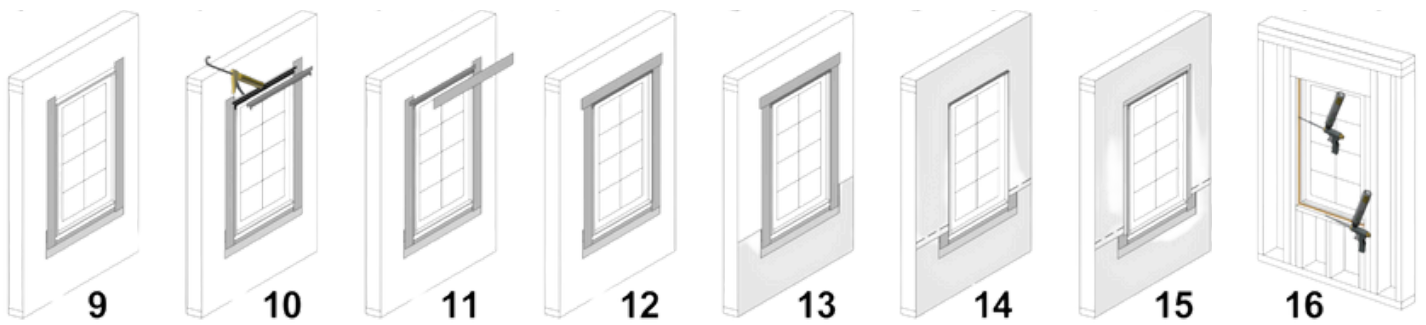

## Step 5: Insulation

1. Place fiberglass insulation (or similar) between the window frame and rough opening.
2. Seal around the perimeter to ensure proper water management and airtightness.

## Step 6: Disposal & Recycling

- If replacing an old window, follow local guidelines for **proper disposal or recycling**.
- For windows with lead-based paint, consult [www.epa.gov/lead](http://www.epa.gov/lead) for safe handling procedures.

## Warnings & Final Checks

✓ Ensure full integration of the window into the building's water management system. ✓ Do not use acid-based cleaners—they can corrode the window and void the warranty. ✓ Verify all fasteners are straight, properly spaced, and penetrate the framing by at least 1”.

For additional questions, visit [www.starwindowscorp.com](http://www.starwindowscorp.com).